

*Conditions apply

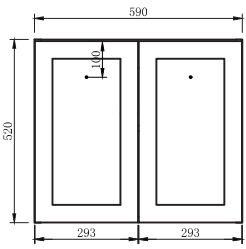

AUSTIN60WH
Front View

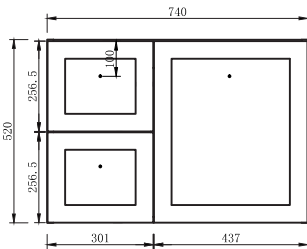

AUSTIN75WH
Front View

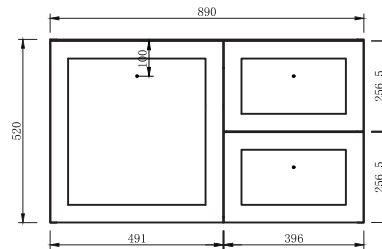

AUSTIN90WH
Front View

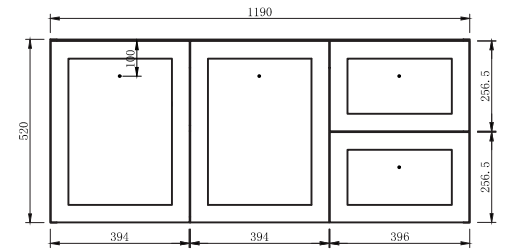

AUSTIN120WH
Front View

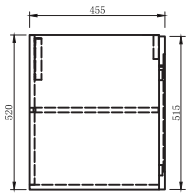

AUSTIN60WH
Side Section

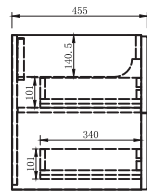

All Other Sizes
Side Section

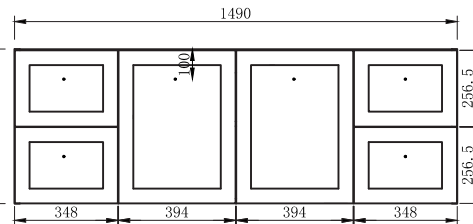

AUSTIN150WH
Front View

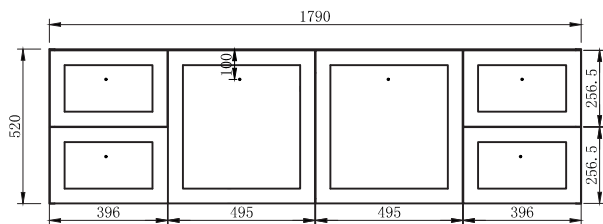

AUSTIN180WH
Front View

FEATURES

- Pre assembled cabinets, ready for installation.
- Moisture resistant 16mm & 18mm board.
- Traditional elegance in a modern design.
- High quality soft close hinges and drawer slides.
- The matte white surface is both easy to clean and stylish.
- Large storage space with a height-adjustable shelf for maximum comfort.

arova[®]

With our policy of continuous improvement, we reserve the right to change or discontinue at any time, specifications or designs without notice. Please confirm all particulars before purchase and have the product at site before rough in. To the extent permitted by law, Arova is not liable for any errors, omissions or misrepresentations of information or for any loss or damage suffered by persons who use or rely on such information.

www.arova.com.au

*The warranty only covers manufacturing faults and defects and does not include wear and tear or water damage.